

Polymeric Kinetic air valve

Automat high quality kinetic air valve for a variety of irrigation systems.

It evacuates air during pipeline filling and enables large volume air intake in the event of system draining.



HIGHLIGHTS

- **Efficient Air Expulsion and Intake:** Due to advance hydraulic design, Large volume of air release/intake capability during pipe filling and pump shut off.
- **Low Pressure Sealing:** New sealing mechanism.
- **Debris Protection:** Venting passage equipped with screen to prevent debris intrusion.
- **Pressure Gauge:** The unit is equipped with optional pressure port.

APPLICATIONS

Kinetic Air Expulsion:

When the pipeline is being filled, the air release valve remains open, expelling surplus air outside the system. Once the pipe is filled with water, the valve closes tightly, ensuring a secure and leak-free seal.

Kinetic Air Admission:

During negative pressure or vacuum conditions within the pipe, the air release valve opens to allow air inside, preventing damage to pipes and accessories by avoiding vacuum-induced stress.

Other Specification

Model No		88P	89P	90P	91P
Kinetic area	mm ²	227	550	908	1962
	In ²	0.35	0.85	1.4	3

Material Specification



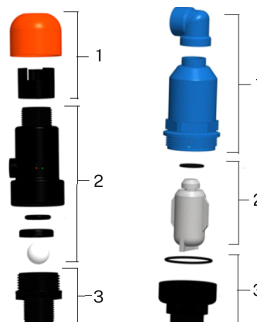

1. Body & Cap- PPGF
2. Base & Elbow - PAGF
3. Rubber parts (Seals & O rings) - EPDM/NBR

Spare Parts list-

1. Body Assembly: Body & Cap
2. Float Assembly: Float, Guide and Seals
3. Base Assembly: Base and o ring



Technical Data (Plastic ARV)

Model No		88P	89P	90P	91P
Inlet Connection		¾", 1" (20, 25 mm)	1", 1½" (25, 40 mm)	2" (50 mm)	3" (80 mm)
					
Connection Type		Male Threaded (BSP/NPT)			Female Threaded (BSP/NPT)
Maximum Working Pressure	BAR	8	10	12	12
	PSI	100	150	175	175
Sealing Pressure	BAR	0.3	0.3	0.1	0.3
	PSI	5	5	2	5

Product Dimensions

Part No	Size	Height (H)		Width (W)		Weight	
		mm	Inch	mm	Inch	Gms	Lbs
88P	¾" & 1"	133	5.2"	46	1.8"	84	0.19
89P	1½"	188	7.4"	80	3.2"	275	0.61
90P	2"	271	10.7"	100	4"	580	1.28
91P	3"	252	9.9"	110	4.3"	536	1.20

